

Hopkins County, KY PVA

Summary

Parcel Number MAP-6-40
 Account Number 44780
 Location Address ARCHIE LN 00321
 Description

(Note: Not to be used on legal documents)

Class Farm
 Tax District 01 County
 2020 Rate Per Thousand 10.1410

[View Map](#)



Owner

Primary Owner
 GRABER LESTER & ARLENE
 321 ARCHIE LN
 DAWSON SPRINGS, KY 42408-

Land Characteristics

[For more information regarding the Flood Zone in Hopkins County \(CLICK HERE\)](#)

Condition	Good	Topography	Rolling
Plat Book/Page		Drainage	
Subdivision		Flood Hazard	
Lot		Zoning	
Block		Electric	Yes
Acres	55.00	Water	Yes
Front	0	Gas	No
Depth	0	Sewer	No
Lot Size	0x0	Road	Secondary
Lot Sq Ft	0	Sidewalks	No
Shape		Information Source	Deed

Valuation

	2024 Certified	2023 Certified	2022 Certified	2021 Certified
+ Land Value	\$12,800	\$12,800	\$12,800	\$12,800
+ Improvement Value	\$197,000	\$197,000	\$157,000	\$157,000
+ Ag Improvement Value	\$29,300	\$29,300	\$9,000	\$9,000
= Total Taxable Value	\$239,100	\$239,100	\$178,800	\$178,800
- Exemption Value	\$0	\$0	\$0	\$0
= Net Taxable Value	\$239,100	\$239,100	\$178,800	\$178,800
+ Land FCV	\$165,000	\$165,000	\$87,100	\$87,100
+ Improvement FCV	\$157,000	\$157,000	\$157,000	\$157,000
+ Ag Improvement FCV	\$29,300	\$29,300	\$9,000	\$9,000
= Total FCV	\$351,300	\$351,300	\$253,100	\$253,100
Exemption				
Farm Acres	55.00	55.00	55.00	55.00
Fire Protection Acres	0.00	0.00	0.00	0.00

Taxes

	2020	2019
Tax	\$1,868.27	\$1,868.27

Improvement Information

Building Number	1	Kitchens	0
Description	DBLE WIDE WITH ADDITION & AG BLDS	Dining Rooms	0
Residence Type	Single Family	Living Rooms	0
Comm Type		Family Rooms	0
Mobile Home Type	MH - Residential	Bedrooms	0
Year Built	2018	Full Baths	0
Effective Age	0	Half Baths	0
Ave. Wall Height	0	Other Rooms	0
Structure	1 Story	Total Rooms	0
Number of Stories	0	Living Sq Ft	1,736
Exterior	Vinyl	Fireplaces/Water	0/1
Foundation	MH Permanent	Supplemental Heat	
Construction Type	Wood Frame	Mobile Home Model	2018 30X76
Construction Quality	MHII: Standard	Mobile Home Manufacturer	
Building Condition	Good	MH Skirt Foundation	Other
Roof Type	Gable	Heat	No
Roof Cover	Comp.Shingles	Heat Source	Electric
Roof Pitch	Low	Heat Type	Forced Air
Basement Type	Walkout	Air Conditioning	No
Basement Finish	All Finished	AC/Type	Central
Basement Size	Full	Special Improvements	No
Basement Sq Ft	0	Fire Alarm	No
Garage/Carport	Garage	Sprinklers	No
Garage Size	2 Car	Porch/Deck	
Garage Type	Basement	Porch Sq Ft	0
Garage Exterior	Other	Deck Sq Ft	0
Width	0	Concrete Sq Ft	0
Length	0	Farm Bldg Type	
Garage Sq Ft	0	Value	\$24,400.00
Pool		Driveway	Gravel
Pool Size	0	Fence	0
Tennis Courts			

Building Number	2	Kitchens	0
Description		Dining Rooms	0
Residence Type		Living Rooms	0
Comm Type		Family Rooms	0
Mobile Home Type		Bedrooms	0
Year Built	0	Full Baths	0
Effective Age	0	Half Baths	0
Ave. Wall Height	0	Other Rooms	0
Structure		Total Rooms	0
Number of Stories	0	Living Sq Ft	0
Exterior		Fireplaces/Water	0/0
Foundation		Supplemental Heat	
Construction Type		Mobile Home Model	
Construction Quality		Mobile Home Manufacturer	
Building Condition		MH Skirt Foundation	
Roof Type		Heat	No
Roof Cover		Heat Source	
Roof Pitch		Heat Type	
Basement Type		Air Conditioning	No
Basement Finish		AC/Type	
Basement Size		Special Improvements	No
Basement Sq Ft	0	Fire Alarm	No
Garage/Carport		Sprinklers	No
Garage Size		Porch/Deck	
Garage Type		Porch Sq Ft	0
Garage Exterior		Deck Sq Ft	0
Width	0	Concrete Sq Ft	0
Length	0	Farm Bldg Type	
Garage Sq Ft	0	Value	\$0.00
Pool		Driveway	Gravel
Pool Size	0	Fence	0
Tennis Courts			

Photos





Sketches

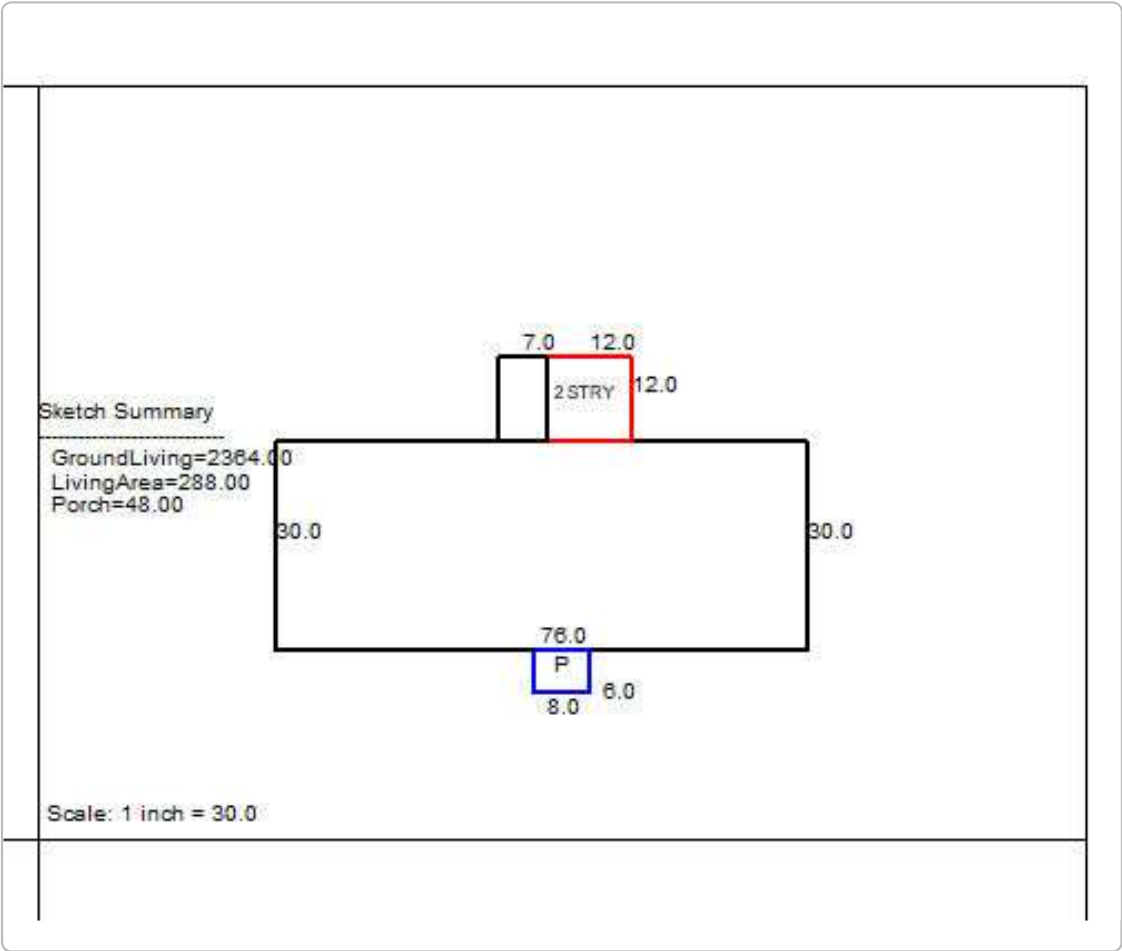

Sale Information

Sale Date ↕	Sale Price ↕	Sale Type ↕	Book-Page ↕	Grantee ↕	Grantor ↕
2/3/2014	\$205,000	Multiple Properties	725-776	GRABER LESTER & ARLENE	BROWN DONALD L & WANDA F
8/1/1988	\$24,200		476-217	BROWN DONALD L & WANDA F	ELI JURILD

The Hopkins County Property Valuation Administrator's Office makes every effort to produce the most accurate information possible. No warranties, expressed or implied, are provided for the data herein, its use or interpretation. The assessment information is from the last certified taxroll. All data is subject to change before the next certified taxroll.

[User Privacy Policy](#) | [GDPR Privacy Notice](#)
Last Data Upload: 9/25/2025, 2:11:03 PM

Contact Us

Developed by
 **SCHNEIDER**
GEOSPATIAL