

GENERAL NOTES

1. NO SEARCH OF PUBLIC RECORDS HAD BEEN COMPLETED BY KEEN SURVEYING, LLC TO DETERMINE ANY DEFECTS AND/OR AMBIGUITIES IN THE TITLE OF THE PARENT PARCEL

2. THIS PROPERTY IS SUBJECT TO ANY RECORDED EASEMENTS AND/OR RIGHT OF WAYS SHOWN HERE OR NOT

LOCATION MAP

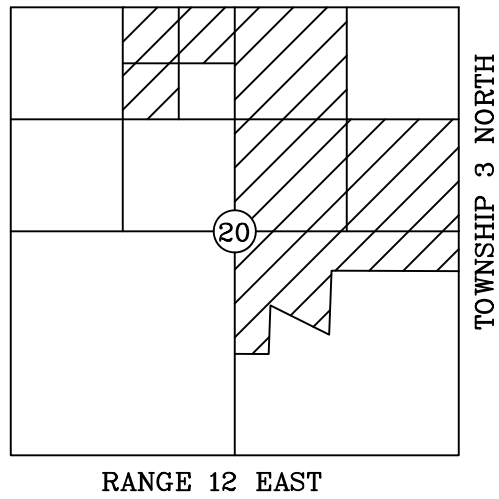

RECORDING INFORMATION

PITTSBURGH COUNTY COMMISSIONERS CERTIFICATE

WE, THE UNDERSIGNED, DO HEREBY CERTIFY THAT THE PLAT OF THE HARMONY HILLS PHASE 1, BEING A SUBDIVISION IN PITTSBURGH COUNTY, OKLAHOMA, TOGETHER WITH THE OWNERS CERTIFICATE AND THE SURVEYORS CERTIFICATE ON THE SAME WERE PRESENTED TO THE COUNTY COMMISSIONERS OF PITTSBURGH COUNTY, OKLAHOMA FOR APPROVAL. THAT SAID PLAT, OWNERS CERTIFICATE AND SURVEYORS CERTIFICATE BEING FOUND TO CONFORM TO THE PLATTING REQUIREMENTS IN ALL RESPECTS, ARE IN ALL THINGS APPROVED ON THIS ____ DAY OF ____ 2025

☐ ROADS WILL BE MAINTAINED BY THE COUNTY

☐ ROADS WILL NOT BE MAINTAINED BY THE COUNTY, PROVIDED HOWEVER THAT THE COUNTY MAY AGREE TO MAINTAIN THE ROADS AT SOME FUTURE DATE

DISTRICT 1 COMMISSIONER

DISTRICT 2 COMMISSIONER

DISTRICT 3 COMMISSIONER

PITTSBURGH COUNTY TREASURERS CERTIFICATE

I, DO HEREBY CERTIFY THAT I AM THE DULY ELECTED AND QUALIFIED ACTING COUNTY TREASURER OF PITTSBURGH COUNTY, STATE OF OKLAHOMA; THAT THE TAX RECORDS OF SAID COUNTY SHOW THAT ALL TAXES ARE PAID FOR THE TAX YEAR 2025 AND PRIOR YEARS ON THE LAND SHOWN ON THE ANNEXED PLAT OF HARMONY HILLS PHASE 1, BEING A SUBDIVISION IN PITTSBURGH COUNTY, OKLAHOMA; THAT THE REQUIRED STATUTORY SECURITY HAS BEEN DEPOSITED IN THE OFFICE OF COUNTY TREASURER, GUARANTEEING PAYMENT OF THE CURRENT YEAR'S TAXES.

WITNESS MY HAND ON THIS ____ DAY OF ____ 2025

COUNTY TREASURER

SURVEYORS CERTIFICATE

I, BRIAN KEEN, LICENSED PROFESSIONAL LAND SURVEYOR NO. 1872 IN THE STATE OF OKLAHOMA, HEREBY CERTIFY THAT THE ANNEXED PLAT OF HARMONY HILLS PHASE 1, BEING A SUBDIVISION IN PITTSBURGH COUNTY, OKLAHOMA, REPRESENTS A TRUE AND CORRECT SURVEY THEREOF MADE UNDER MY SUPERVISION ON THE 1ST DAY OF MAY, 2025 AND THAT ALL MONUMENTS SHOWN HEREON ACTUALLY EXIST AND THEIR POSITIONS ARE CORRECTLY SHOWN. I ALSO CERTIFY THAT THE SURVEY AND PLAT THEREOF MEETS OR EXCEEDS THE OKLAHOMA MINIMUM STANDARDS FOR THE PRACTICE OF LAND SURVEYING AS ADOPTED BY THE OKLAHOMA STATE BOARD OF LICENSURE FOR PROFESSIONAL ENGINEERS AND LAND SURVEYORS.

BRIAN KEEN, OKLAHOMA LICENSED PROFESSIONAL LAND SURVEYOR NO. 1872

STATE OF ARKANSAS)
COUNTY OF IZARD)

BEFORE ME, THE UNDERSIGNED, A NOTARY PUBLIC IN AND FOR SAID COUNTY AND STATE, ON THIS ____ DAY OF ____ 2025, PERSONALLY APPEARED, BRIAN KEEN, TO ME KNOWN TO BE THE IDENTICAL PERSON WHO SIGNED THE NAME OF THE MAKER THEREOF TO THE WITHIN AND FOREGOING INSTRUMENT AS ITS OWNER AND ACKNOWLEDGED TO ME THAT HE EXECUTED THE SAME AS HIS FREE AND VOLUNTARY ACT AND DEED FOR THE USES AND PURPOSES THEREIN SET FORTH

MY COMMISSION EXPIRES THE ____ DAY OF ____

NOTARY PUBLIC

MAP PREPARED FOR:

CLASSIC COUNTRY LAND LLC

OKLAHOMA COA #6967

KEEN SURVEYING, LLC

203 SOUTH MAIN STREET P.O. BOX 234

SALEM, ARKANSAS 72576

TEL (870) 895-3600 FAX (870) 895-3614

EMAIL: BRIAN@KEENSURVEYING.COM

WWW.KEENSURVEYING.COM

DATE: 5/7/25

SCALE: 1" = 300'

DRAWN BY: B.KEEN

CHECKED BY: B.KEEN

JOB #1769.107