

eFiled & eRecorded
DATE: 12/27/2023
TIME: 6:52 PM
PLAT BOOK: 00018
PAGE: 00072
RECORDING FEES: \$10.00
PARTICIPANT ID: 1519108864
CLERK: Michael A. King
Pulaski County, GA

NOTES:
SURVEYOR HAS MADE NO INVESTIGATION
OR INDEPENDENT SEARCH FOR EASEMENTS
OF RECORD, ENCUMBRANCES, RESTRICTIVE
COVENANTS, OWNERSHIP TITLE EVIDENCE
OR ANY OTHER FACTS THAT AN ACCURATE
AND CURRENT TITLE SEARCH MAY DISCLOSE.

THE BEARINGS SHOWN ON THIS PLAT ARE BASED UPON
GRID NORTH-GA EAST ZONE. GRID NORTH WAS TAKEN
FROM GPS OBSERVATION AND IS NOT ADJUSTED TO
GEODETIC MONUMENTATION.

CURRENT OWNERS: COUNTRY LOTS, LLC
TAX PARCEL: 3T811980001
DB 312 PG 255
PLAT REF'S: PB 17 PG 159, PB 17 PG 185
PB 15 PG 143
1/2"RBS or 5/8"RBS AT TRACT CORNERS
PLAT E.O.C.: 1' IN 444,397' BOUNDARY

THE PROPERTY HEREON LIES COMPLETELY WITHIN A JURISDICTION WHICH DOES NOT
REVIEW OR APPROVE ANY PLATS OR THIS TYPE OF PLAT PRIOR TO RECORDING.
RECORDATION OF THIS PLAT DOES NOT IMPLY APPROVAL OF ANY LOCAL JURISDICTION,
AVAILABILITY OF PERMITS, COMPLIANCE WITH LOCAL REGULATIONS OR REQUIREMENTS, OR
SUITABILITY FOR ANY USE OR PURPOSE OF THE LAND. FURTHERMORE, THE UNDERSIGNED
LAND SURVEYOR CERTIFIES THAT THIS PLAT COMPLIES WITH THE MINIMUM TECHNICAL
STANDARDS FOR PROPERTY SURVEYS IN GEORGIA AS SET FORTH IN THE RULES AND
REGULATIONS OF THE GEORGIA BOARD OF REGISTRATION FOR ENGINEERS AND
PROFESSIONAL LAND SURVEYORS AND AS SET FORTH IN O.C.G.A. SECTION 15-6-67.

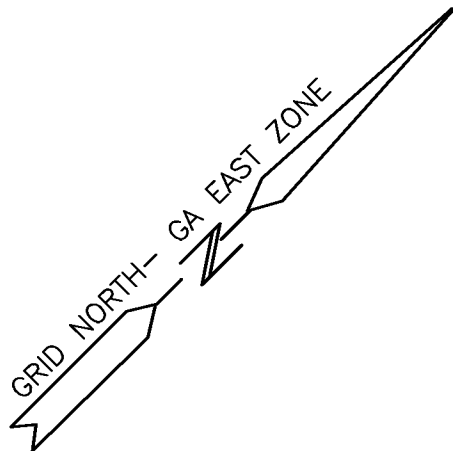

DODGE COUNTY

PULASKI COUNTY

PITTMAN CEMETERY
AREA= 0.08 ACRES

PITTMAN CEMETERY LINES

Course	Bearing	Distance
1	N 75°44'56" E	72.35'
2	S 19°29'55" E	98.39'
3	N 53°57'05" W	127.35'

PITTMAN CEMETERY IS
3 OBSERVED GRAVES

PLAT REVISED: 21 DEC. 2023
TO SHOW PITTMAN CEMETERY AND
REVISE TRACT #1

STATE OF GEORGIA
PULASKI COUNTY
LAND DISTRICT #20th
LAND LOT #198

PLAT DATE: 12 JANUARY 2021
FIELD DATE: 05 JANUARY 2021

THIS SURVEY PERFORMED USING RTK
SURVEYING METHODS. ALL SURVEY
CONTROL COLLECTED WITH GPS HAS A
TOLERANCE OF 0.05' WITH A 95%
CONFIDENCE LEVEL.
EQUIPMENT USED: STONEX S10 GNSS
BASE AND ROVER
ELECTRONIC TOTAL STATION

IPS= IRON PIN SET
IPF= IRON PIN FOUND
RBF= REBAR FOUND
RBS= REBAR SET
CMF= CONCRETE MONUMENT FOUND
CMS= CONCRETE MONUMENT SET

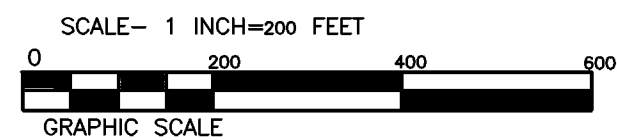

FILE #200919
DRAWN BY: ADE

SURVEY OF:
T.J. FARMS
SURVEY FOR:
COUNTRY LOTS, LLC

TOTAL AREA SURVEYED:
AREA= 121.38 ACRES

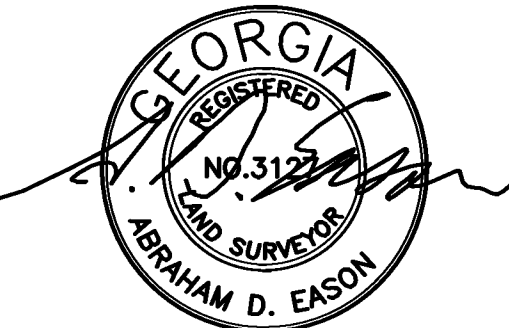

EASON LAND SURVEYING
P.O. BOX 753
CLAXTON, GA. 30417
(912) 739-7143
LSF 000047